



## hd EZ lock™ Universal HDMI™ Lock Quick Start Installation Guide

Below are the most common methods of installing hd EZ lock. Identify the proper install method for your component(s) and then go to the proper section for detailed instructions.

To view the online version, visit:  
[www.blueechosolutions.com/info/hd-ez-lock-installation-guides/](http://www.blueechosolutions.com/info/hd-ez-lock-installation-guides/)

|  |   |
|--|---|
|  | <b>Method 1</b> – Install using the existing screw above your HDMI Input.                                   |
|  | <b>Method 2</b> – Install using the existing screw below your HDMI Input.                                   |
|  | <b>Method 3</b> – Install using Standoff Adapter when HDMI Input is recessed.                               |
|  | <b>Method 4</b> – Install multiple hd EZ lock™ in a staggered configuration when HDMI Inputs are too close. |
|  | <b>Method 5</b> – Install using Adhesive when there is no screw above or below HDMI Input.                  |

**To reduce risk of electronic shock to yourself or others, or damage to your equipment, unplug all components from their power source before beginning to install hd EZ lock™.**

Do not use hd EZ lock™ if you are not comfortable making the necessary Modifications to your equipment.

hd EZ lock™ is manufactured in the USA.  
U.S. Patent Number 7,914,338.



### Method 1: Standard Installation – Using the existing screw ABOVE your HDMI Input.

|                                 |                             |                  |                    |
|---------------------------------|-----------------------------|------------------|--------------------|
|                                 |                             |                  |                    |
| M3x.5 6mm Socket Cap Screw (x2) | 6/32" x 3/8" Set Screw (x2) | 2mm Hex Key (x1) | 1/16" Hex Key (x1) |

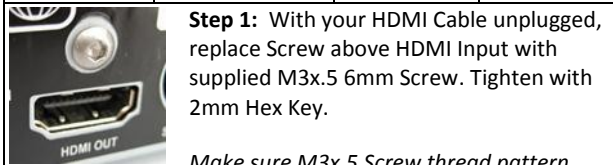

**Step 1:** With your HDMI Cable unplugged, replace Screw above HDMI Input with supplied M3x.5 6mm Screw. Tighten with 2mm Hex Key.

*Make sure M3x.5 Screw thread pattern matches existing screw thread. If not, you may be able to use the existing screw. If you have problems with this, contact us for assistance.*

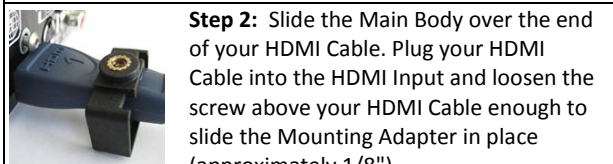

**Step 2:** Slide the Main Body over the end of your HDMI Cable. Plug your HDMI Cable into the HDMI Input and loosen the screw above your HDMI Cable enough to slide the Mounting Adapter in place (approximately 1/8").

*Make sure the notches on the Main Body are facing away from the chassis.*

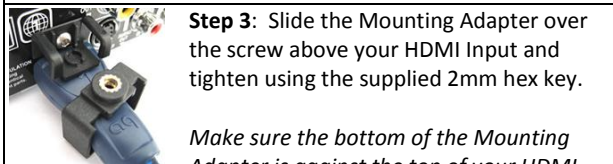

**Step 3:** Slide the Mounting Adapter over the screw above your HDMI Input and tighten using the supplied 2mm hex key.

*Make sure the bottom of the Mounting Adapter is against the top of your HDMI*

*Cable.*

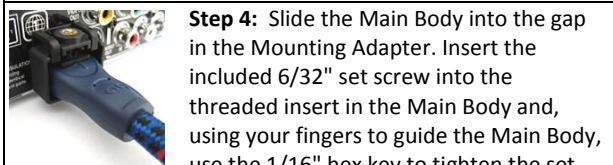

**Step 4:** Slide the Main Body into the gap in the Mounting Adapter. Insert the included 6/32" set screw into the threaded insert in the Main Body and, using your fingers to guide the Main Body, use the 1/16" hex key to tighten the set screw tight enough to grip your HDMI Cable.

*Do not over tighten. Tighten until you feel resistance, then an additional two to three turns is enough to hold firmly in place.*

### Method 2: Standard Installation – Using the existing screw BELOW your HDMI Input.

|                                 |                             |                  |                    |
|---------------------------------|-----------------------------|------------------|--------------------|
|                                 |                             |                  |                    |
| M3x.5 6mm Socket Cap Screw (x2) | 6/32" x 3/8" Set Screw (x2) | 2mm Hex Key (x1) | 1/16" Hex Key (x1) |

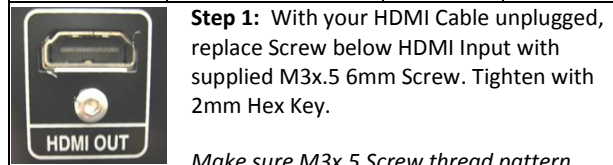

**Step 1:** With your HDMI Cable unplugged, replace Screw below HDMI Input with supplied M3x.5 6mm Screw. Tighten with 2mm Hex Key.

*Make sure M3x.5 Screw thread pattern matches existing screw thread. If not, you may be able to use the existing screw. If you have problems with this, contact us for assistance.*

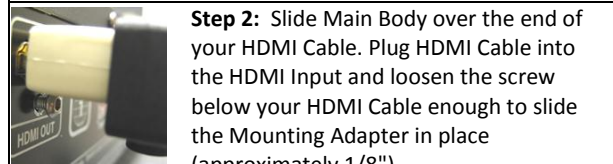

**Step 2:** Slide Main Body over the end of your HDMI Cable. Plug HDMI Cable into the HDMI Input and loosen the screw below your HDMI Cable enough to slide the Mounting Adapter in place (approximately 1/8").

*Make sure the notches on the Main Body are facing away from the chassis.*

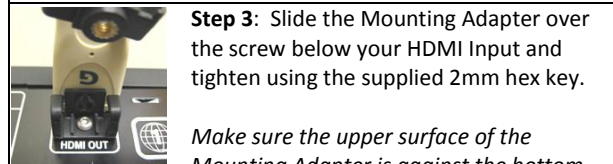

**Step 3:** Slide the Mounting Adapter over the screw below your HDMI Input and tighten using the supplied 2mm hex key.

*Make sure the upper surface of the Mounting Adapter is against the bottom of your HDMI Cable.*

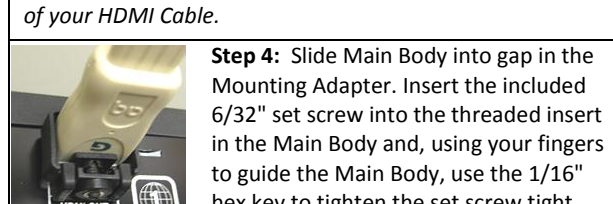

**Step 4:** Slide Main Body into gap in the Mounting Adapter. Insert the included 6/32" set screw into the threaded insert in the Main Body and, using your fingers to guide the Main Body, use the 1/16" hex key to tighten the set screw tight enough to grip HDMI Cable.

*Do not over tighten. Tighten until you feel resistance, then additional two to three turns is enough to hold firmly in place.*

**Method 3: Standoff Installation – Using the existing screw with a recessed HDMI Input.**

|  |                                      |                                      |                        |                          |
|--|--------------------------------------|--------------------------------------|------------------------|--------------------------|
|  |                                      |                                      |                        |                          |
| M3x.5<br>6mm<br>Socket Cap<br>Screw (x2) | M3x.5<br>Standoff<br>Adapter<br>(x2) | 6/32" x<br>3/8" Set<br>Screw<br>(x2) | 2mm<br>Hex Key<br>(x1) | 1/16"<br>Hex Key<br>(x1) |

**Step 1:** Remove existing screw above /below HDMI Input and replace with M3x.5 10mm Standoff Adapter. Screw M3x.5 6mm Screw into end of Standoff Adapter, Leave about 1/8" gap.

*Make sure supplied M3 Screw/Standoff Adapter matches the thread pattern of the existing screw before replacing it. If the thread pattern is different, contact us for assistance.*

**Step 2:** Slide Main Body over end of HDMI Cable. Plug HDMI Cable into HDMI Input and make sure screw above HDMI Cable has enough space to slide the Mounting Adapter in place (approximately 1/8").

*Make sure the notches on the Main Body are facing away from the chassis.*

**Step 3:** Slide the Mounting Adapter over the screw on the end of the Standoff Adapter, above your HDMI Input and tighten the screw using the supplied 2mm hex key.

*Make sure the bottom of the Mounting Adapter is against the top of your HDMI Cable.*

**Step 4:** Slide Main Body into gap in the Mounting Adapter. Insert included 6/32" set screw into threaded insert in the Main Body. Using your fingers to guide the Main Body, use 1/16" hex key to tighten set screw tight enough to grip HDMI Cable.

*Do not over tighten. Tighten until you feel resistance, then an additional two/ three turns is enough to hold firmly in place.*

**Method 4: Staggered Installation – Using multiple hd EZ locks™ with close HDMI Input.**

|                                       |                                      |                                      |                           |                             |
|---------------------------------------|--------------------------------------|--------------------------------------|---------------------------|-----------------------------|
|                                       |                                      |                                      |                           |                             |
| M3x.5 6mm<br>Socket Cap<br>Screw (x2) | M3x.5<br>Standoff<br>Adapter<br>(x2) | 6/32" x<br>3/8" Set<br>Screw<br>(x2) | 2mm<br>Hex<br>Key<br>(x1) | 1/16"<br>Hex<br>Key<br>(x1) |

**Step 1:** Remove the existing screw above your HDMI Input and replace with (alternating with each HDMI Input) an M3x.5 Standoff Adapter OR a M3x.5 6mm Screw (use 2mm Hex key to tighten). Screw an M3x.5 6mm Screw into the end of the Standoff Adapter, but do not tighten completely (leave about 1/8" gap).

*Make sure supplied M3 Screw/Standoff Adapter matches the thread pattern of the existing screw before replacing it. If the thread pattern is different, contact us for assistance.*

**Step 2:** Slide the Main Body over the end of your HDMI Cable. Plug your HDMI Cable into the HDMI Input and loosen the screw above your HDMI Cable enough to slide the Mounting Adapter in place (approximately 1/8").

*Make sure the notches on the Main Body are facing away from the chassis.*

**Step 3:** Slide the Mounting Adapter over the screw above your HDMI Input and tighten using the supplied 2mm hex key.

*Make sure bottom of the Mounting Adapter is against top of HDMI Cable.*

**Step 4:** Slide Main Body into gap in the Mounting Adapter. Insert included 6/32" set screw into threaded insert in the Main Body and, using fingers to guide the Main Body, use 1/16" hex key to tighten set screw tight enough to grip HDMI Cable.

*Do not over tighten. Tighten until you feel resistance, then an additional two to three turns is enough to hold firmly in place.*

**Method 5: Adhesive Installation – Using with no screw above or below your HDMI Input.**

|                                   |                                   |                                 |                          |
|-----------------------------------|-----------------------------------|---------------------------------|--------------------------|
|                                   |                                   |                                 |                          |
| 6/32" x 3/8"<br>Set Screw<br>(x2) | 3M VHB<br>Adhesive<br>Strips (x2) | IPA Alcohol<br>Prep Pad<br>(x1) | 1/16"<br>Hex Key<br>(x1) |

**Step 1:** Using the supplied IPA Prep Pads, thoroughly clean both the back of the Mounting Adapter and the area on your component where the adhesive will be applied. Dry with a clean cloth.

*Preparation is very important for adhesive to work properly. Make sure surface is dry before proceeding. Do not touch either surface after cleaning.*

**Step 2:** Slide Main Body over end of HDMI Cable. Plug HDMI Cable into the HDMI Input.

*Make sure the notches on the Main Body are facing away from the chassis.*

**Step 3:** Remove one side of adhesive lining and apply to the back of Mounting Adapter. Apply firm pressure for 30-60 seconds. Remove second lining and apply Mounting Adapter to chassis, applying firm pressure for 30-60 seconds.

*Center Mounting Adapter on your HDMI Cable and make sure bottom of Mounting Adapter is directly against top of your HDMI Cable. For best results, allow the adhesive to sit for 24 hours before proceeding to the next step.*

**Step 4:** Slide the Main Body into the gap in the Mounting Adapter. Insert the included 6/32" set screw into the threaded insert in the Main Body and, using your fingers to guide the Main Body, use the 1/16" hex key to tighten the set screw tight enough to grip your HDMI Cable.

*Do not over tighten. Tighten until you feel resistance, then an additional two to three turns is enough to hold firmly in place.*

U.S. Patent Number 7,914,338

